

ROGER WALL PILOT CHEAT SHEET

Connecting

Remove Wall Pilot Cover



Turn On

Slide power to On



Connect to Roger Touchscreen

1. Roger device must be turned on to connect
2. Hold Roger Touchscreen Mic within 5cm
3. From the Home page on the wall pilot press 'OK' button
4. Use arrow and 'OK' button to select the following options. Select "Network", "Join Net" & "Yes".

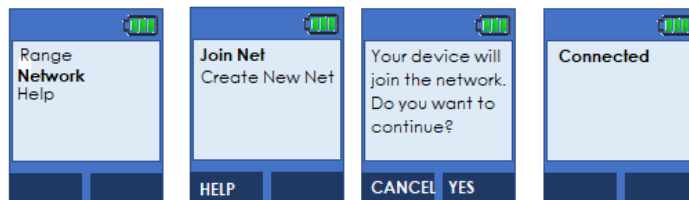
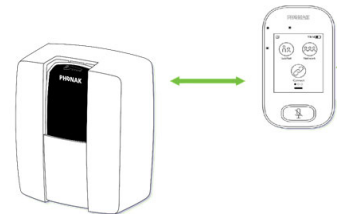

5. The screen will show "Connected".

Compatible Devices

Roger MyLink



Hearing Aid with Roger™ X (02) Receiver



Cochlear Implant with Mini Mic 2 Processor & Roger™ Receiver



Troubleshooting

Tips

- Ensure that cables are connected equipment is connected with 3.5mm cables from projector or TV.
- Check cable is connected at wall plate front and back.
- Volume is up on all equipment that is being used.
- A digital to analogue converter may be required when connecting to a TV, if TV speakers are silent (Contact HA).